



**IMPACT
ENVIRONMENTAL
GROUP**

CS3 STATIC WASTE COMPACTOR

with Enclosed hopper

Scan me to find out more



Specification

Our CS3 static compactors are mainly used for dry general waste i.e. general office waste, broken pallets, furniture, window frames, textiles, etc.

With fast cycle time, high volume charge box, heavy duty compaction and low noise levels, our static waste compactors are the perfect choice to minimise your waste costs. Available in a range of colours, with clear operating instructions and health and safety stickers as standard. Easy to operate, safe to use and backed by a network of our own engineers to ensure maximum reliability.



IEG products are also covered with a **12 Month Warranty**, so you can rely on us to maintain hygienic and sustainable community & commercial spaces.

Technical Information

COMPACTION FORCE	27 Tonnes
POWER REQUIREMENT	32A 3Ph + N + E Socket outlet fused at 32Amp D type with local 30 Milliamp RCD protection
If you have an existing supply that doesn't match this specification, please contact technical@iegemea.com to check if it's usable or discuss a solution)	
MOTOR	7.5kW
NOISE LEVEL	70dB at 3m From Unit
CYCLE TIME	45 Seconds
CHARGE BOX VOLUME	2.29m ³
VOLUME PER STROKE	2.00m ³
RAM DEPTH	700 mm
RAM DIAMETER	150mm
RUNNING HYDRAULIC PRESSURE	2000 psi
PINNING HYDRAULIC PRESSURE	2150 psi
OVERALL DIMENSIONS	3406mm (L) x 3320mm (H) x 1600mm (W)(+ 2510mm for safety enclosure)
VARIANT SHOWN	Enclosed loading hopper and sliding door

All machines are built following the CE and UKCA guidance and legislation

The details provided in our specification sheets are for your general information and use only.

They are subject to change due to the continual design and build development.



Unit 9E, Vinnetrow Business Park,
Vinnetrow Road, Chichester, West
Sussex, PO20 1QH

+44 (0) 1243 837614
enquiries@iegemea.com
iegemea.com

Capital Compactors and Balers trading as IMPACT ENVIRONMENTAL GROUP



QMS⁺ ISO 9001 : 2015 REGISTERED

QMS⁺ ISO 14001 : 2015 REGISTERED

Realise your sustainability goals, partner with IEG

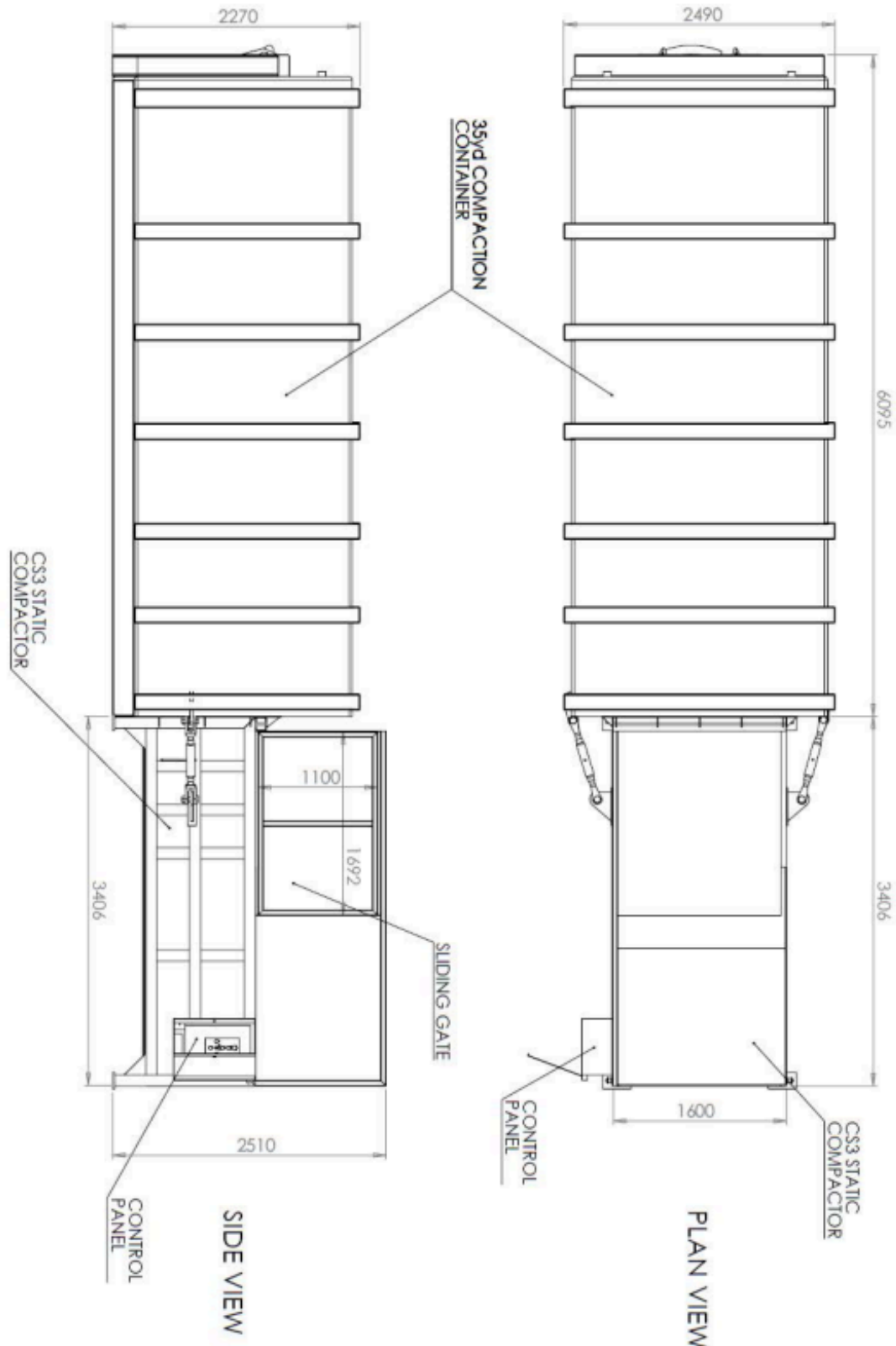

The details provided in our specification sheets are for your general information and use only.
They are subject to change due to the continual design and build development.



Unit 9E, Vinnetrow Business Park,
Vinnetrow Road, Chichester, West
Sussex, PO20 1QH

+44 (0) 1243 837614
enquiries@iegemea.com
iegemea.com

Capital Compactors and Balers trading as IMPACT ENVIRONMENTAL GROUP



QMS⁺ ISO 9001 : 2015
REGISTERED

QMS⁺ ISO 14001 : 2015
REGISTERED